

- Decorative radiators ■ Comfortable indoor ventilation
- Heating and cooling ceilings ■ Industrial air cleaning

Zehnder EVO 3

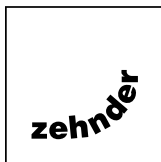

- EN Quick Guide
- IT Guida Rapida
- FR Guide Rapide

- EN
- IT
- FR



always the best climate

Zehnder EVO 3 ventilation unit

Refer to the full installation and use manuals for additional information and instructions. To download them, scan the QR codes at the back of this quick guide.

Zehnder EVO 3 is a centralised mechanical ventilation unit with high-efficiency recovery unit (recovery of heat alone in HRV units, recovery of heat and humidity in ERV units) which expels stale air while simultaneously supplying fresh air to rooms.

It can be installed in homes, offices and similar locations.

Safety instructions - General notes

- Zehnder EVO 3 can only be used if it has been installed by a specialist engineer in accordance with current regulations and the instructions provided in the full installation manual.
- Do not open or modify the ventilation unit. Physical or software changes cause the loss of warranty cover and may lead to malfunctions or personal injury.
- Do not start up the ventilation unit when open: the electrical voltage and the movement of the fans may cause personal injury.

 **Unless otherwise required in this manual, keep the unit operating at all times. Otherwise, damp may build up and mould may form.**

 **WARNING! Hazardous electric voltage.**

- In the event of a natural disaster, disconnect the power supply.

 **Safety instructions - Installation**

- Always comply with general and local regulations with regard to building construction, safety and installation. Install a safety circuit breaker for disconnection of the power supply. Comply with the instructions provided in the installer manual.
- Connected to a 230 V - 50 Hz mains power supply; a circuit breaker should be installed.
- Install the unit in a location where the temperature and humidity are always within the range specified in the installation manual.
- Do not install in locations with saunas or swimming-pools, excessive humidity, excessive dust or harmful or potentially corrosive substances.
- Check that there is sufficient space for the air distribution system in the installation area. Leave the ventilation unit completely accessible to enable maintenance procedures.

Installation

⚠️ Disconnect the power supply.

Check the spaces available before starting installation.

The fittings for connection to the distribution system can be turned through 90°. Follow the instructions provided in the installation manual.

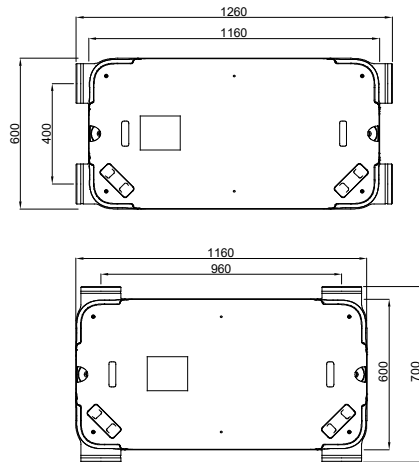

Handle the Zehnder EVO unit with care. Two people are always required to lift the unit. Do not lift the unit by the fittings as this may damage them.

Open the top of the cardboard packaging. Lift the ventilation unit and place it on a clean, soft surface. Use the cardboard box as template for drilling the holes required for installation.

The brackets supplied can be used on either the long or the short side of the unit. In the latter case, the supports already installed on the unit have to be moved to new positions. Refer to the installation manual.

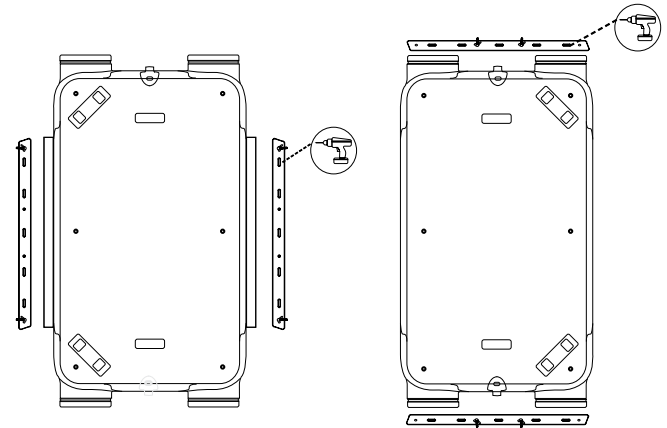

The unit can be ceiling-mounted in the default “factory version” or in “mirror version”, obtained by placing a jumper over connectors 9 and 10.

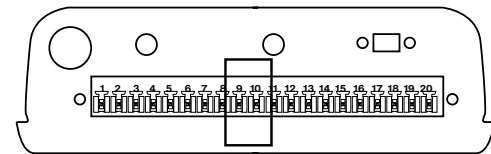

When ceiling-mounted, the unit must NOT be sloping; it must be levelled.

EN

IT

FR

⚠ This diagram **ONLY** applies for ceiling-mounting

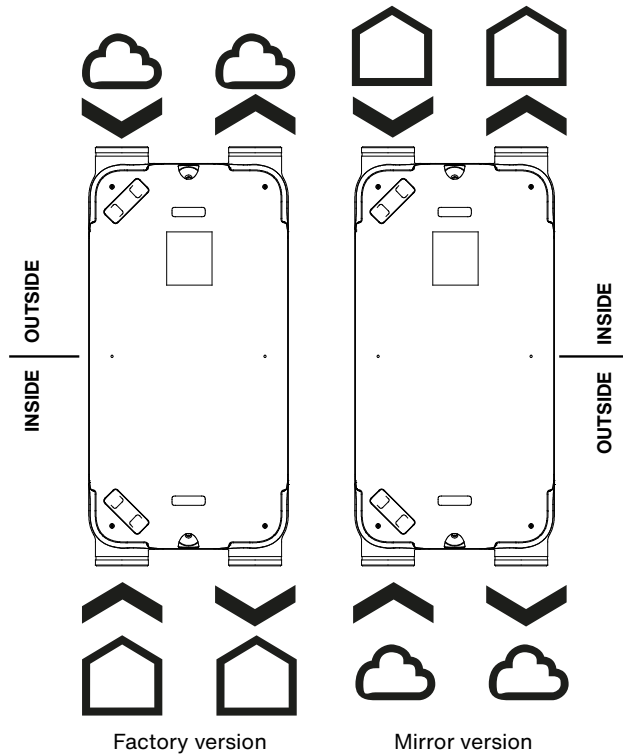

IMPORTANT!

Modification of the model from right-hand to left-hand "Mirror version" is **NOT** possible for models: EVO 3 HRV PR and EVO 3 ERV PR

⚠ For wall-mounting, the following instructions **MUST** be complied with.

The unit must be installed vertically, and levelled on the vertical plane, to enable effective condensate drainage.

The unit must only be installed with the control board connector facing upward.

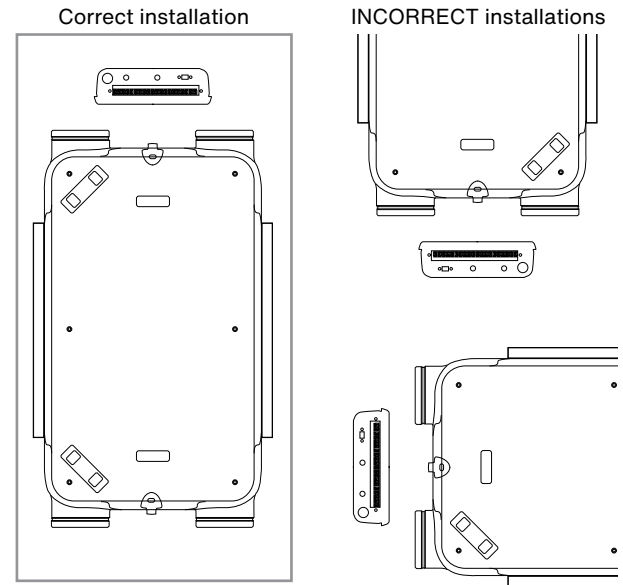

EN

IT

FR

The HRV unit must **ONLY** be installed in “mirror version”, with the outside air inlet and stale air outlet connection point facing downward

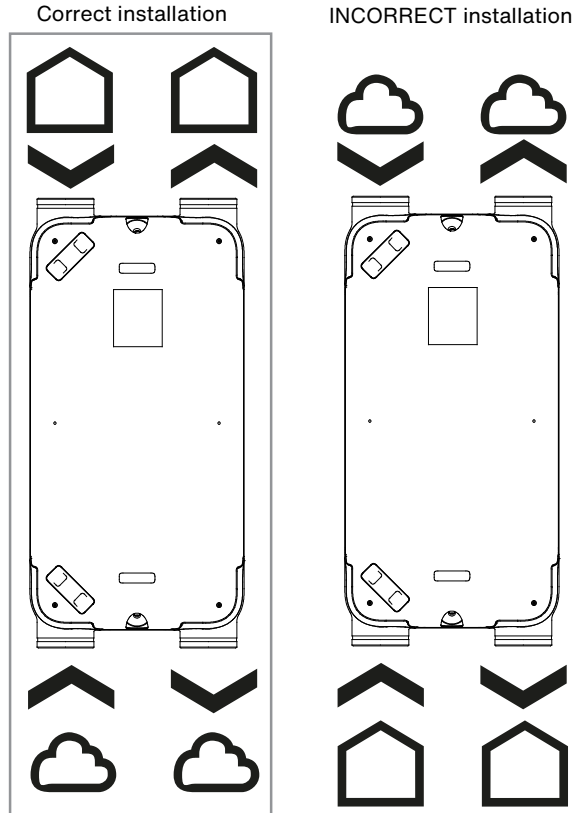

Installing the condensate drain

Zehnder EVO 3 HRV and Zehnder EVO 3 HRV PR units must be connected to a condensate drain system with unobstructed flow, protected from frost.

Screw the 1/2" male threaded siphon (not included in the supply package, must be ordered separately) onto the unit's condensate drain fitting. Install the siphon so that it can easily be removed during maintenance.

The unit's condensate drain connection may be pointing horizontally or downwards.

In the event of horizontal installation, the gradient of the condensate drain system must not be horizontal or towards the unit.

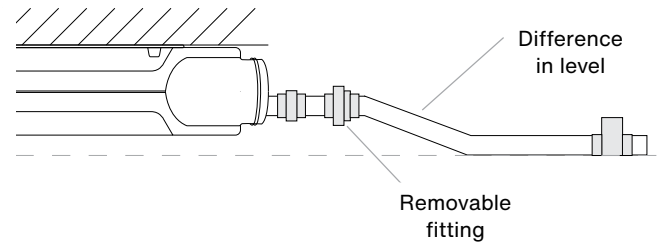

In EVO 3 HRV and EVO 3 HRV PR units only one condensate drain is connected; the other one must be plugged.
In EVO 3 ERV and EVO 3 ERV PR units both condensate drains must be plugged.
The plugs are supplied.

Schematic diagram

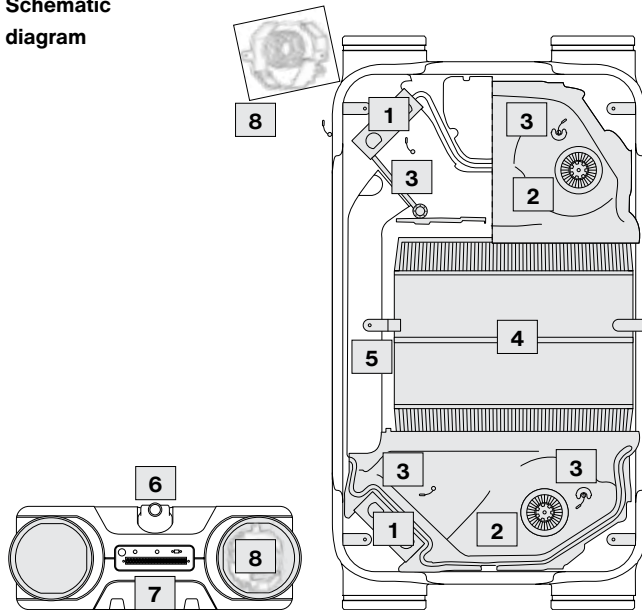

| | |
|---|--|
| 1 | High-performance filters |
| 2 | Energy-saving fans |
| 3 | Temperature sensors |
| 4 | High-efficiency heat exchanger |
| 5 | Automatic bypass |
| 6 | Condensate drain |
| 7 | Electrical connections |
| 8 | Electric preheater (in HRV PR and ERV PR versions) |

Control accessories

The unit is supplied WITHOUT control accessories. Refer to the user manual or installation manual for the accessories available.

The following is an overview of the electrical connections

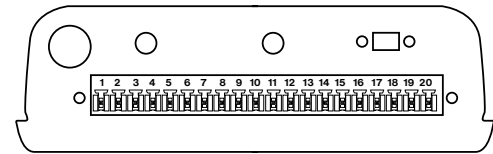

| | | | |
|----|-------------------------------------|----|-------------------------------|
| 1 | Home automation - 10 V | 11 | Not used |
| 2 | Home automation - 0 V | 12 | Selector switch V1 common |
| 3 | Home automation - volt free contact | 13 | Selector switch V2 |
| 4 | Home automation - volt free contact | 14 | Selector switch V3 |
| 5 | Not used | 15 | Preheater 230 V output (**) |
| 6 | Not used | 16 | Preheater ground output (**) |
| 7 | After-heater 10 V output (*) | 17 | Preheater neutral output (**) |
| 8 | After-heater 10 V output 0 V (*) | 18 | Not used |
| 9 | "Mirror mode" NO/NC (*) | 19 | Not used |
| 10 | "Mirror mode" NO/NC (*) | 20 | Not used |

(*) Pin not used on models Zehnder EVO 3 HRV PR and Zehnder EVO 3 ERV PR

(**) In models with preheater included as standard, these pins are used for the after-heater (optional) and not for the preheater

EN

IT

FR

Zehnder unità di ventilazione EVO 3

Per ulteriori informazioni e istruzioni, consultare i manuali completi di installazione e uso. Per scaricarli, scansionare i QR code riportati in fondo a questa guida rapida.

Zehnder EVO 3 è una unità di ventilazione meccanica centralizzata con recuperatore ad alta efficienza (recupero del solo calore per le unità HRV, recupero di calore e umidità per le unità ERV), che permette di espellere l'aria viziata e, allo stesso tempo, fornire aria di rinnovo agli ambienti.

Può essere installato in ambienti domestici, uffici e assimilabili.



Istruzioni di sicurezza - Note generali

- Zehnder EVO 3 può essere utilizzata solo se installata da un tecnico specializzato, nel rispetto delle normative vigenti e delle indicazioni contenute nel manuale completo di installazione.
- Non aprire nè modificare l'unità di ventilazione. Una modifica fisica o del software provoca il decadimento della garanzia, e può provocare malfunzionamenti o lesioni personali.
- Non accendere l'unità di ventilazione quando è aperta: la tensione elettrica e il movimento dei ventilatori possono provocare lesioni personali.



Se non diversamente richiesto nel presente manuale, mantenere l'unità sempre in funzione. In caso contrario, potrebbe verificarsi l'accumulo di umidità e la formazione di muffa.



ATTENZIONE! Tensione elettrica pericolosa.

- In caso di calamità naturale, scollegare l'alimentazione elettrica.



Istruzioni di sicurezza - Installazione

- Osservare sempre le norme generali e locali in materia di edilizia, sicurezza e installazione. Installare un interruttore sezionatore di sicurezza per poter scollegare l'alimentazione elettrica. Osservare le indicazioni contenute nel manuale installatore.
- Collegare a una rete elettrica 230 V - 50 Hz, è raccomandata l'installazione di un sezionatore.
- Installare l'unità in ambiente climatizzato, in cui temperatura e umidità rimangono all'interno dei range specificati nel manuale installazione.
- Non installare in ambienti in cui vi siano saune o piscine, umidità eccessiva, polveri eccessive, sostanze nocive o potenzialmente corrosive.
- Verificare che vi sia spazio sufficiente nell'area di installazione per il sistema di distribuzione dell'aria. Lasciare l'unità di ventilazione completamente accessibile per consentire le operazioni di manutenzione.

EN

IT

FR

Installazione

⚠ Disconnettere l'alimentazione elettrica.

Verificare gli spazi disponibili prima di iniziare l'installazione.

Le bocche di connessione alla distribuzione possono essere ruotate di 90°. Seguire le istruzioni riportate sul manuale di installazione.

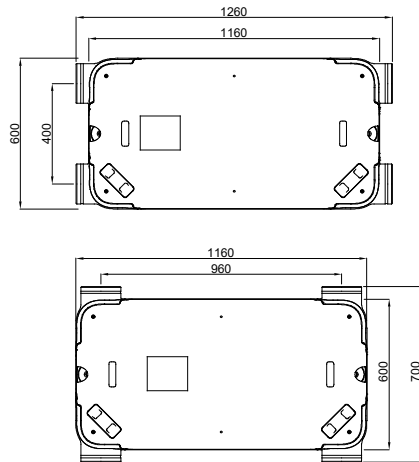

Maneggiare l'unità Zehnder EVO con cura. Per sollevare l'unità sono sempre necessarie due persone. Evitare di afferrare i raccordi perchè potrebbero danneggiarsi.

Aprire la parte superiore dell'imballaggio in cartone. Sollevare l'unità di ventilazione e posizionarla su una superficie morbida e pulita. Utilizzare il cartone come dima di foratura.

Le staffe in dotazione possono essere utilizzate sia sul lato lungo che sul lato corto dell'unità. In quest'ultimo caso, occorre riposizionare i supporti pre-installati sull'unità. Consultare il manuale di installazione.

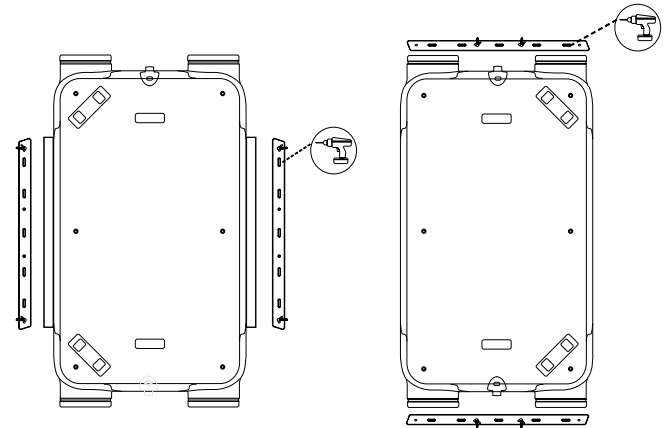

E' possibile installare l'unità a soffitto nella versione di fabbrica "factory version" oppure nella modalità "mirror version", ponticellando i connettori 9 e 10.

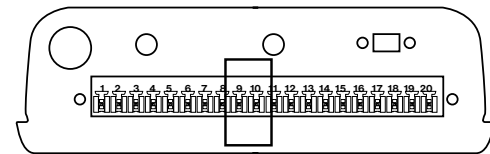

L'unità a soffitto NON deve essere pendenzata, ma installata in bolla.

EN

IT

FR

! Questo schema è valido SOLO per l'installazione a soffitto

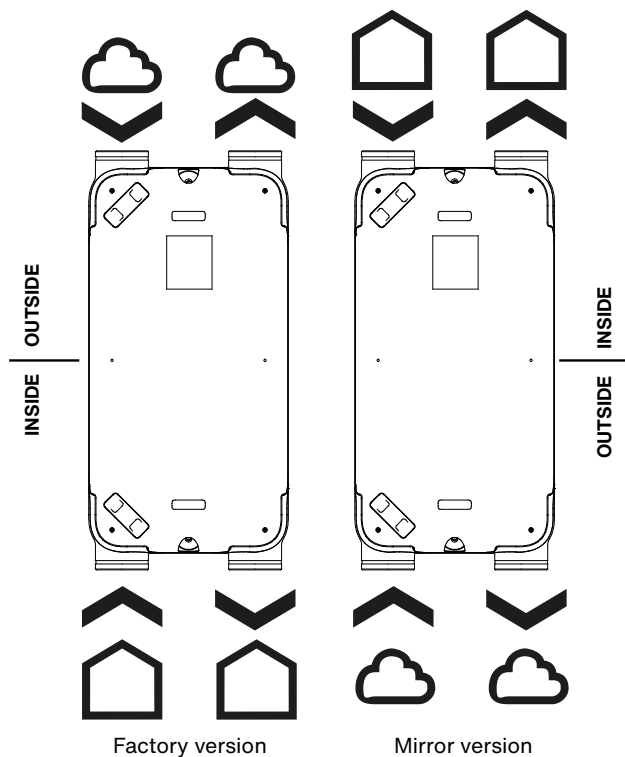

IMPORTANTE!

La modifica del modello da destro a sinistro "Mirror version" NON è possibile per i modelli: EVO 3 HRV PR e EVO 3 ERV PR

! Per l'installazione a parete è **NECESSARIO** rispettare le seguenti indicazioni.

L'unità deve essere installata in bolla, in verticale, per permettere il corretto scarico della condensa.

L'unità deve essere installata con il connettore della scheda elettronica rivolto verso l'alto.

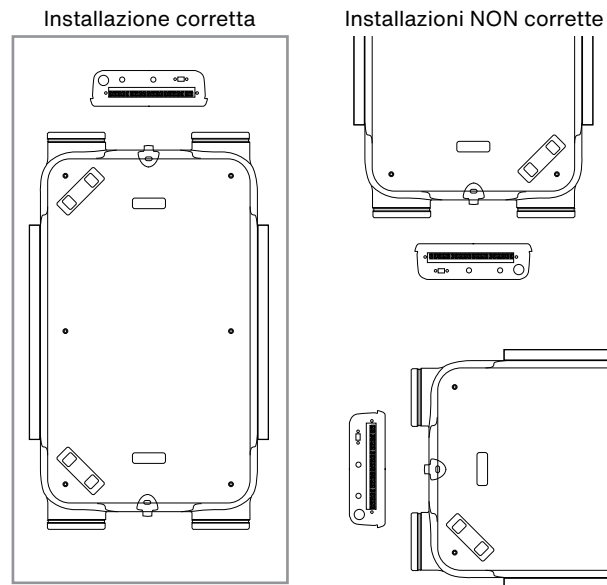

EN

IT

FR

L'unità HRV deve essere installata SOLO nella versione "mirror version", con presa aria esterna ed espulsione rivolte verso il basso

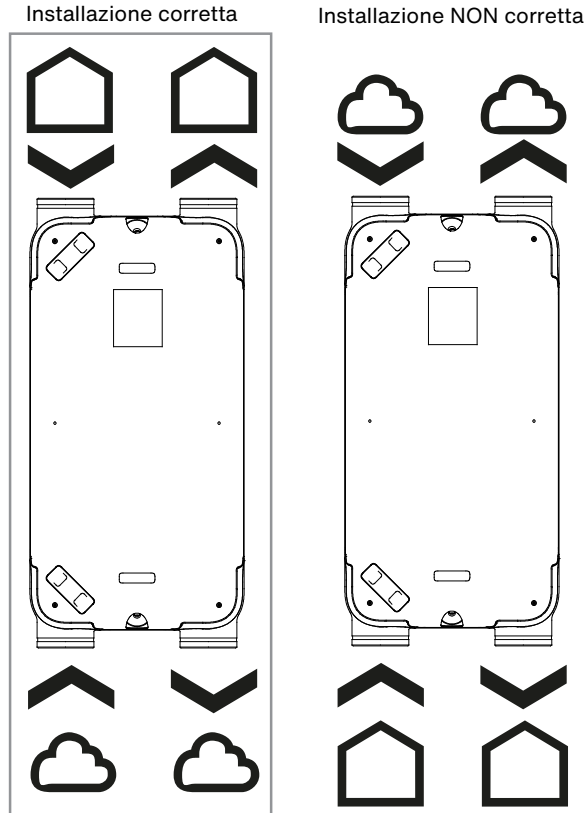

Installazione scarico condensa

I modelli Zehnder EVO 3 HRV e Zehnder EVO 3 HRV PR devono essere connessi a una rete di scarico condensa pervia e non soggetta a gelo.

Avvitare il sifone filettato maschio da 1/2" (non incluso nella fornitura, deve essere ordinato separatamente) al raccordo di scarico condensa dell'unità. Installare il sifone in modo che possa essere smontato facilmente durante le operazioni di manutenzione.

La connessione dello scarico condensa sull'unità può essere rivolta in orizzontale o verso il basso.

In caso di installazione orizzontale, la pendenza della rete di scarico condensa non deve essere orizzontale né rivolta verso l'unità.

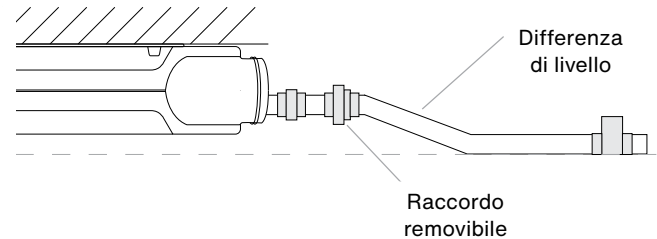

Nelle unità EVO 3 HRV e EVO 3 HRV PR viene collegato un solo scarico condensa, l'altro deve essere tappato.

Nelle unità EVO 3 ERV e EVO 3 ERV PR entrambi gli scarichi condensa devono essere tappati.

I tappi sono inclusi nella fornitura.

EN

IT

FR

Esploso dell'unità

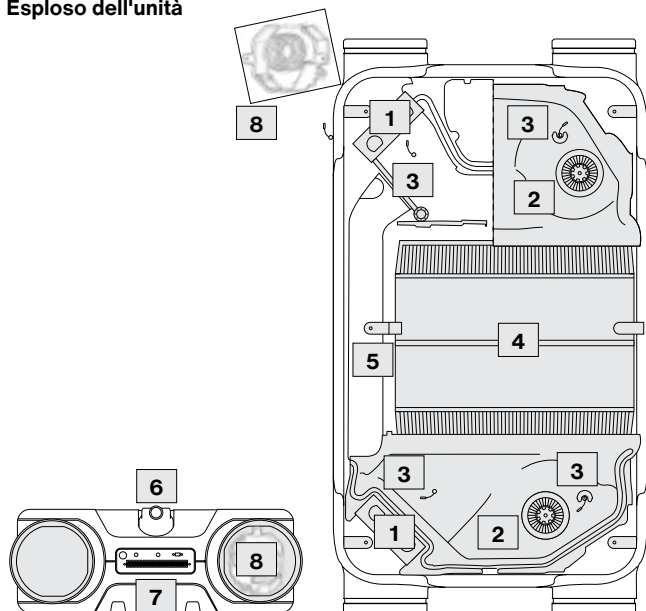

| | |
|---|---|
| 1 | Filtri ad alte prestazioni |
| 2 | Ventilatori a basso consumo |
| 3 | Sensori di temperatura |
| 4 | Scambiatore di calore ad alta efficienza |
| 5 | Bypass automatico |
| 6 | Scarico condensa |
| 7 | Connessioni elettriche |
| 8 | Preriscaldamento elettrico (nelle versioni HRV PR e ERV PR) |

Accessori di regolazione

L'unità viene fornita **SENZA** accessori di regolazione.

Consultare il manuale utente o il manuale di installazione per gli accessori disponibili.

A seguito una panoramica dei collegamenti elettrici

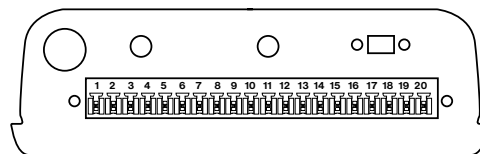

| | | | |
|----|----------------------------|----|------------------------------|
| 1 | Home automation - 10 V | 11 | Non utilizzato |
| 2 | Home automation - 0 V | 12 | Comune selettore V1 |
| 3 | Home automation- c. pulito | 13 | Selettore V2 |
| 4 | Home automation- c. pulito | 14 | Selettore V3 |
| 5 | Non utilizzato | 15 | Output pre risc. 230 V (**) |
| 6 | Non utilizzato | 16 | Output pre risc. terra (**) |
| 7 | Output post risc. 10 V (*) | 17 | Output pre risc. neutro (**) |
| 8 | Output post risc. 0 V (*) | 18 | Non utilizzato |
| 9 | "Mirror mode" NA/NC (*) | 19 | Non utilizzato |
| 10 | "Mirror mode" NA/NC (*) | 20 | Non utilizzato |

(*) Pin non usati nei modelli Zehnder EVO 3 HRV PR e Zehnder EVO 3 ERV PR

(**) Nei modelli con preriscaldamento incluso come standard, questi pin sono utilizzati per il post-riscaldamento (opzionale) e non per il preriscaldamento.

EN

IT

FR

Unité de ventilation Zehnder EVO 3

Pour plus d'informations et de consignes, veuillez vous reporter aux manuels complets d'installation et d'utilisation. Pour les télécharger, scannez les codes QR insérés à la fin de ce guide rapide.

L'unité de ventilation mécanique centralisée Zehnder EVO 3 est équipée d'un récupérateur à haut rendement (récupération de chaleur uniquement sur les unités HRV, récupération de chaleur et d'humidité sur les unités ERV), lequel permet d'évacuer l'air vicié tout en assurant l'alimentation en air frais des pièces concernées. Ce dispositif est susceptible d'être installé dans des habitations, bureaux et lieux similaires.

Consignes de sécurité - Généralités

- L'unité Zehnder EVO 3 ne peut s'utiliser qu'après avoir été installée par un technicien spécialisé, conformément à la réglementation en vigueur et aux consignes énoncées dans le manuel d'installation complet.
- Ne tentez pas d'ouvrir ni de modifier l'unité de ventilation. Toute intervention matérielle ou logicielle non autorisée entraînera la nullité de la garantie et risquerait de provoquer des dysfonctionnements ou d'occasionner des lésions corporelles.
- Ne tentez pas de mettre en marche l'unité de ventilation lorsqu'elle est ouverte : la tension électrique et la rotation des ventilateurs sont susceptibles d'occasionner des lésions corporelles.

 **Sauf indication contraire précisée dans ce manuel, l'unité doit fonctionner sans discontinuer. Sinon, on ne peut exclure l'accumulation de condensation et la prolifération de moisissures.**

 **AVERTISSEMENT ! Tension électrique dangereuse.**

- Dans l'éventualité d'une catastrophe naturelle, coupez l'alimentation électrique.

 **Consignes de sécurité - Installation**

- Conformez-vous systématiquement à la réglementation générale et locale en vigueur en matière de construction, de sécurité, de réglementation électrique et d'installation. Procédez à l'installation d'un disjoncteur de sécurité en vue de toute déconnexion de l'alimentation électrique. Suivez les consignes énoncées dans le manuel d'installation.
- Raccordez l'équipement à une alimentation 230 V - 50 Hz, installez un disjoncteur de sécurité dédié.
- Installez l'unité de ventilation dans un environnement tempéré, où la température et l'humidité demeurent dans les limites des plages spécifiées dans le manuel d'installation.
- Abstenez-vous d'installer ce dispositif à proximité de saunas, de piscines ou dans des lieux caractérisés par une humidité excessive, un empoussièrement excessif ou bien la présence de substances nocives ou potentiellement corrosives.
- Assurez-vous que la zone d'installation est suffisamment spacieuse pour accueillir le système de distribution d'air. Veillez à ce que l'unité de ventilation demeure suffisamment accessible pour permettre l'exécution des procédures de maintenance.

EN

IT

FR

Installation

⚠ Débranchez l'alimentation électrique.

Vérifiez les espaces disponibles avant de commencer l'installation. Les connecteurs pivotants au système de distribution pivotent à 90°. Conformez-vous aux consignes énoncées dans le manuel d'installation.

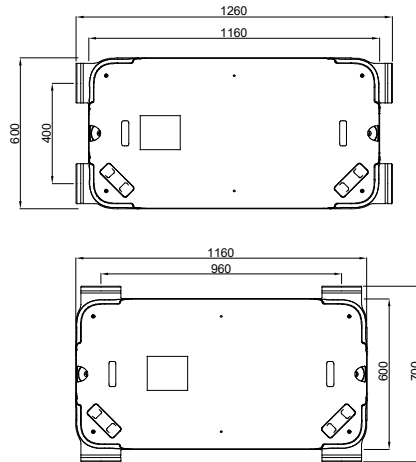

Manipulez l'unité Zehnder EVO avec précaution. Tout déplacement de l'unité de ventilation requiert toujours l'intervention de deux personnes. Évitez de vous en saisir par les connecteurs pivotants, au risque de les endommager.

Ouvrez la partie supérieure de l'emballage en carton. Sortez l'unité de ventilation et placez-la sur une surface propre et lisse. Servez-vous de la boîte en carton comme gabarit de perçage.

Les supports fournis se montent, au choix, du côté long ou du côté court de l'unité. Dans ce dernier cas de figure, il convient de repositionner les supports préinstallés sur l'unité. Reportez-vous au manuel d'installation.

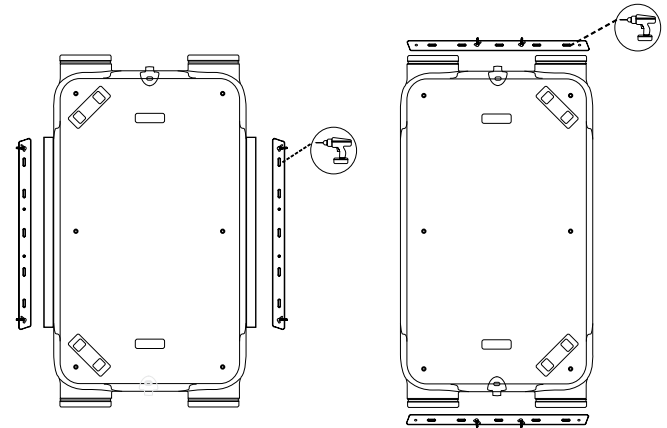

Cette unité est susceptible d'être montée au plafond dans sa « version d'usine » ou dans sa « version miroir » ; pour ce faire, il suffit de ponter un cavalier entre les bornes 9 et 10.

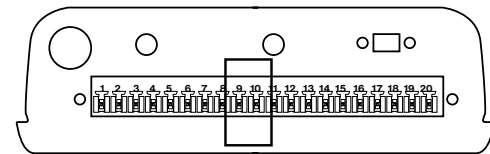

En cas de montage au plafond, cette unité ne doit présenter aucune inclinaison. L'emploi d'un niveau à bulle est indispensable.

EN

IT

FR

⚠ Ce schéma s'applique UNIQUEMENT à une installation au plafond

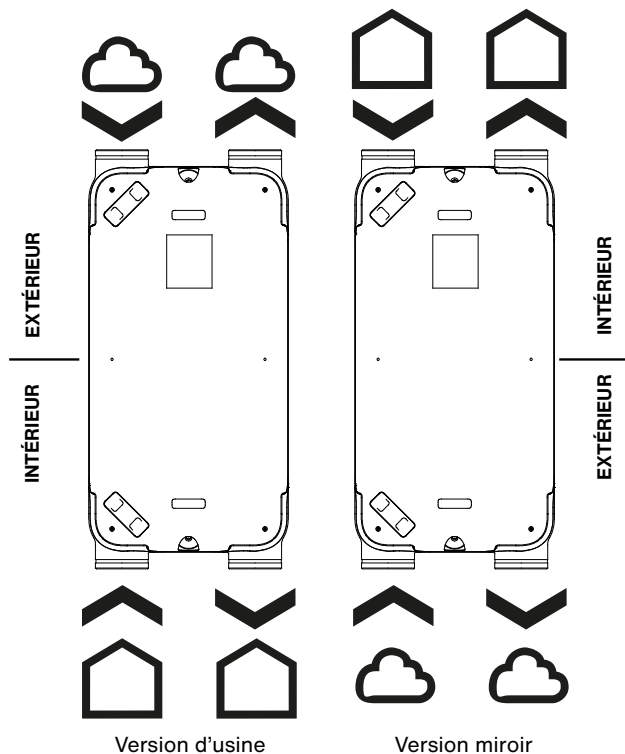

IMPORTANT !

Aucune conversion de la « version droite » en « version gauche »
« version miroir » n'est possible avec les modèles suivants :
EVO 3 HRV PR et EVO 3 ERV PR

⚠ En cas d'installation murale, IL EST NECESSAIRE de se conformer aux consignes qui suivent.

Il convient d'installer l'unité à la verticale et de la mettre à niveau par rapport au plan vertical afin de permettre une évacuation efficace des condensats.

Lors de son installation, vous devez veiller à ce que le connecteur de la carte de commande à circuit intégré soit orienté vers le haut.

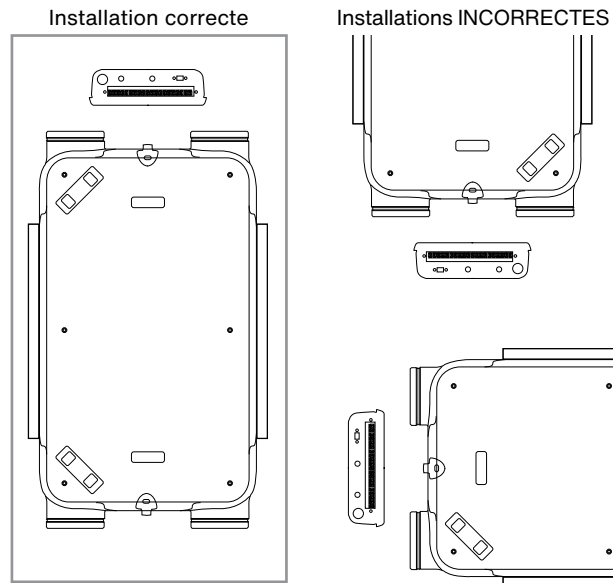

EN

IT

FR

Procédez **UNIQUEMENT** à l'installation d'une unité équipée d'un échangeur chaleur (HRV) en « version miroir », en veillant à ce que les connecteurs d'air extérieur et d'évacuation d'air vicié soient orientés vers le bas.

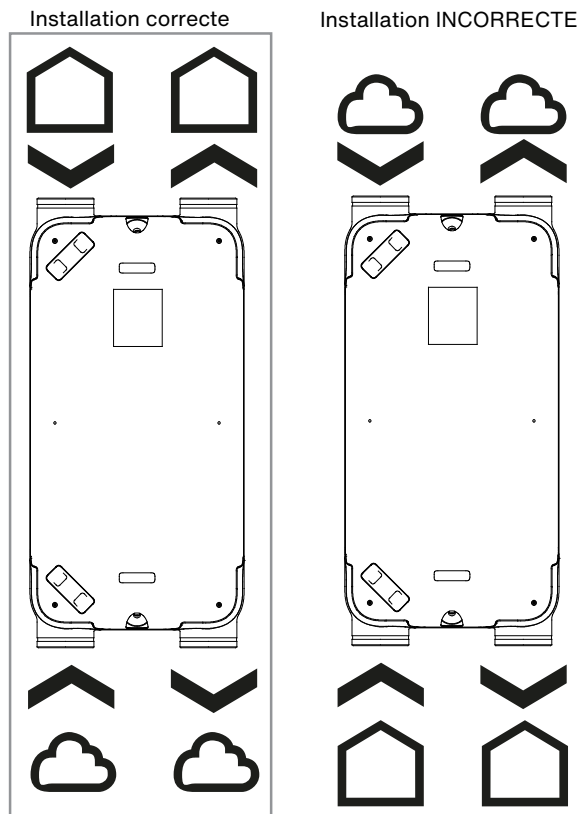

Installation du réseau d'évacuation des condensats

Les unités Zehnder EVO 3 HRV et Zehnder EVO 3 HRV PR doivent être raccordées à un réseau d'évacuation des condensats protégé contre le gel et garantissant un écoulement libre de toute obstruction.

Vissez le siphon à filet mâle 1/2" (non inclus dans les fournitures, composant à commander séparément) sur le raccord d'évacuation des condensats de l'unité. Installez le siphon de manière à permettre un retrait facile lors des opérations de maintenance.

Ce raccord d'évacuation des condensats est orientable à l'horizontale ou vers le bas.

En cas d'installation à l'horizontale, il faut veiller à ce que la pente de la canalisation d'évacuation des condensats ne soit ni horizontale ni inclinée vers l'unité.

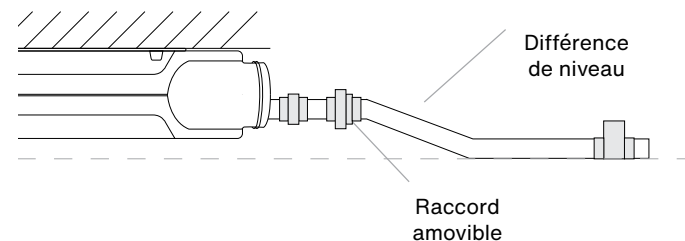

Sur les unités EVO 3 HRV et EVO 3 HRV PR, un seul purgeur de condensats est raccordé ; l'autre doit être obturé.

Sur les unités EVO 3 ERV et EVO 3 ERV PR, les deux purgeurs de condensats doivent être obturés.

Les bouchons sont fournis.

EN

IT

FR

Schéma éclaté de l'unité

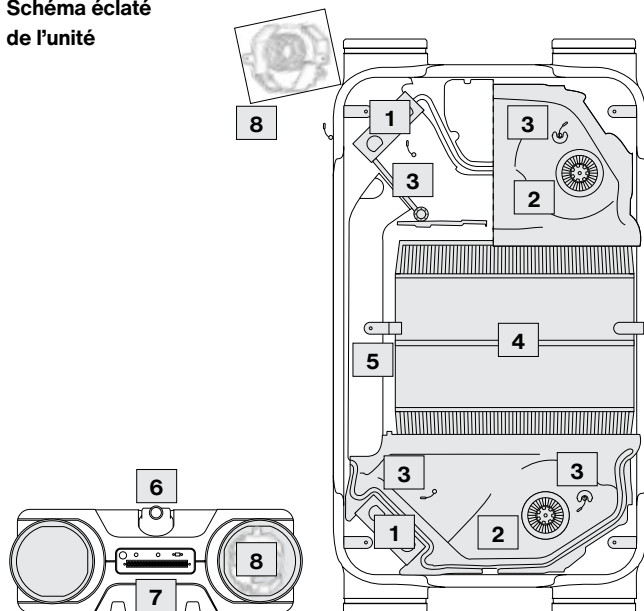

| | |
|---|---|
| 1 | Filtres à hautes performances |
| 2 | Ventilateurs à faible consommation d'énergie |
| 3 | Sondes de température |
| 4 | Échangeur thermique à haut rendement |
| 5 | Dérivation automatique |
| 6 | Purgeur de condensats |
| 7 | Connexions électriques |
| 8 | Préchauffeur électrique (sur les versions HRV PR et ERV PR) |

Accessoires de régulation

Cette unité est livrée SANS accessoires de régulation. Pour étudier les accessoires disponibles, reportez-vous aux manuels d'installation et d'utilisation.

Voici un aperçu des connexions électriques.

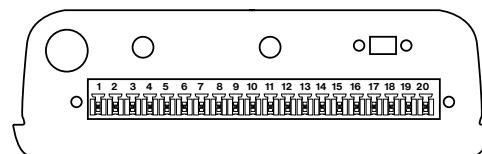

| | | | |
|----|---|----|--|
| 1 | Automatisation domestique - 10 V | 11 | Inutilisée |
| 2 | Automatisation domestique - 0 V | 12 | Sélecteur V1 commun |
| 3 | Automatisation domestique - contact sec | 13 | Sélecteur V2 |
| 4 | Automatisation domestique - contact sec | 14 | Sélecteur V3 |
| 5 | Inutilisée | 15 | Sortie 230 V du préchauffeur (**) |
| 6 | Inutilisée | 16 | Sortie à la terre du préchauffeur (**) |
| 7 | Sortie 10 V du postchauffeur (*) | 17 | Sortie neutre du préchauffeur (**) |
| 8 | Sortie 0 V du postchauffeur (*) | 18 | Inutilisée |
| 9 | « Mode miroir » NO/NF (*) | 19 | Inutilisée |
| 10 | « Mode miroir » NO/NF (*) | 20 | Inutilisée |

(*) Broche inutilisée sur les modèles Zehnder EVO 3 HRV PR et Zehnder EVO 3 ERV PR

(**) Sur les modèles équipés d'origine d'un préchauffeur, ces broches sont affectées au postchauffeur (en option) et non au préchauffeur.

EN

IT

FR

Declaration of performance – Zehnder EVO 3 HRV / EVO 3 HRV PR

Release data: 15/11/2024

Product Datasheet According to Regulation (EU) NO.1254/2014 – ANNEX IV

| Supplier's name or trade mark | Zehnder Group | | | Zehnder Group | | | Zehnder Group | | | Zehnder Group | | |
|--|---|-------|-------|---|-------|-------|---|-------|-------|---|-------|-------|
| Supplier's model identifier | Zehnder EVO 3 HRV / EVO 3 HRV PR | | | Zehnder EVO 3 HRV / EVO 3 HRV PR | | | Zehnder EVO 3 HRV / EVO 3 HRV PR | | | Zehnder EVO 3 HRV / EVO 3 HRV PR | | |
| SEC [kWh/(m ³ a)] specific energy consumption (cold, average, warm) | -66,7 | -41,2 | -14,4 | -67,4 | -41,8 | -14,7 | -68,6 | -42,8 | -15,5 | -71 | -44,5 | -17,6 |
| SEC class (cold, average, warm) climate | A+ | A | E | A+ | A | E | A+ | A+ | E | A+ | A+ | E |
| Typology of unit of ventilation | UVR bidirectional | | | | | | | | | | | |
| Typology of drive installed | Multi-speed control | | | Multi-speed control | | | Variable speed control | | | Variable speed control | | |
| Type of heat recovery system | Heat Recovery Static | | | Heat Recovery Static | | | Heat Recovery Static | | | Heat Recovery Static | | |
| Thermal efficiency [%] | 88,9 | | | 88,9 | | | 88,9 | | | 88,9 | | |
| Maximum flow rate [m ³ /h] | 300 | | | 300 | | | 300 | | | 300 | | |
| Electric power input of the fan drive [W] | 131,5 | | | 131,5 | | | 131,5 | | | 131,5 | | |
| Level of power acoustics (LWA) [dB(A)] | 45 | | | 45 | | | 45 | | | 45 | | |
| Reference flow [m ³ /h] | 210 | | | 210 | | | 210 | | | 210 | | |
| Reference pressure difference [Pa] | 50 | | | 50 | | | 50 | | | 50 | | |
| Specific Power Input of reference flow (SPI) [W/(m ³ h)] | 0,25 | | | 0,25 | | | 0,25 | | | 0,25 | | |
| Control factor and typology installed or destined tube installed | "1 Manual control" | | | "0,95 Timer" | | | "0,85 Control environmental centralized" | | | "0,65 Control of demand local" | | |
| Maximum internal and external leakage rate declared [%] | Internal: 4 | | | Internal: 4 | | | Internal: 4 | | | Internal: 4 | | |
| | External: 4,3 | | | External: 4,3 | | | External: 4,3 | | | External: 4,3 | | |
| Position and description of the warning of the filter visual | Warning in the screen of the unit or controller of hall | | | Warning in the screen of the unit or controller of hall | | | Warning in the screen of the unit or controller of hall | | | Warning in the screen of the unit or controller of hall | | |
| Internet address for technical documentation | www.zehnder.it | | | www.zehnder.it | | | www.zehnder.it | | | www.zehnder.it | | |
| Annual electricity consumption by climate (cold, average, warm) per surface area of 100 m ² (AEC) [kWh/a] | 895 | 358 | 313 | 865 | 327 | 283 | 808 | 271 | 226 | 714 | 177 | 132 |
| Annual heating savings in a (cold, average, warm) climate for an apartment with a surface area of 100 m ² (AHS) [kWh/a] | 7566 | 3868 | 1749 | 7601 | 3885 | 1757 | 7670 | 3921 | 1770 | 7810 | 3990 | 1810 |

Important notice

Ensure there are air filters to keep the recovery unit's energy efficiency high, and regularly carry out cleaning and replacement maintenance. Read the instructions in the use and maintenance manual.

Warning

Always ensure a filter is used. To prevent reduced effectiveness of your energy recovery ventilation, be sure to clean dirt and dust from the filter and heat exchange element at regular intervals. See the operating instructions manual.

Declaration of performance – Zehnder EVO 3 ERV / EVO 3 ERV PR

Release data: 15/11/2024

Product Datasheet According to Regulation (EU) NO.1254/2014 – ANNEX IV

| Supplier's name or trade mark | Zehnder Group | | | Zehnder Group | | | Zehnder Group | | | Zehnder Group | | |
|--|---|-------|-------|---|-------|-------|---|-------|-------|---|-------|-------|
| Supplier's model identifier | Zehnder EVO 3 ERV / EVO 3 ERV PR | | | Zehnder EVO 3 ERV / EVO 3 ERV PR | | | Zehnder EVO 3 ERV / EVO 3 ERV PR | | | Zehnder EVO 3 ERV / EVO 3 ERV PR | | |
| SEC [kWh/(m ³ a)] specific energy consumption (cold, average, warm) | -62,2 | -38,6 | -13,4 | -62,9 | -39,2 | -13,7 | -64,1 | -40,2 | -14,5 | -66,5 | -41,9 | -15,7 |
| SEC class (cold, average, warm) climate | A+ | A | E | A+ | A | E | A+ | A | E | A+ | A | E |
| Typology of unit of ventilation | UVR bidirectional | | | | | | | | | | | |
| Typology of drive installed | Multi-speed control | | | Multi-speed control | | | Variable speed control | | | Variable speed control | | |
| Type of heat recovery system | Heat Recovery Static | | | Heat Recovery Static | | | Heat Recovery Static | | | Heat Recovery Static | | |
| Thermal efficiency [%] | 74,3 | | | 74,3 | | | 74,3 | | | 74,3 | | |
| Maximum flow rate [m ³ /h] | 300 | | | 300 | | | 300 | | | 300 | | |
| Electric power input of the fan drive [W] | 129 | | | 129 | | | 129 | | | 129 | | |
| Level of power acoustics (LWA) [dB(A)] | 45 | | | 45 | | | 45 | | | 45 | | |
| Reference flow [m ³ /h] | 210 | | | 210 | | | 210 | | | 210 | | |
| Reference pressure difference [Pa] | 50 | | | 50 | | | 50 | | | 50 | | |
| Specific Power Input of reference flow (SPI) [W/(m ³ h)] | 0,24 | | | 0,24 | | | 0,24 | | | 0,24 | | |
| Control factor and typology installed or destined tube installed | "1 Manual control" | | | "0,95 Timer" | | | "0,85 Control environmental centralized" | | | "0,65 Control of demand local" | | |
| Maximum internal and external leakage rate declared [%] | Internal: 0,92 | | | Internal: 0,92 | | | Internal: 0,92 | | | Internal: 0,92 | | |
| | External: 0,54 | | | External: 0,54 | | | External: 0,54 | | | External: 0,54 | | |
| Position and description of the warning of the filter visual | Warning in the screen of the unit or controller of hall | | | Warning in the screen of the unit or controller of hall | | | Warning in the screen of the unit or controller of hall | | | Warning in the screen of the unit or controller of hall | | |
| Internet address for technical documentation | www.zehnder.it | | | www.zehnder.it | | | www.zehnder.it | | | www.zehnder.it | | |
| Annual electricity consumption by climate (cold, average, warm) per surface area of 100 m ² (AEC) [kWh/a] | 890 | 353 | 308 | 860 | 322 | 278 | 803 | 264 | 221 | 709 | 172 | 127 |
| Annual heating savings in a (cold, average, warm) climate for an apartment with a surface area of 100 m ² (AHS) [kWh/a] | 7512 | 3638 | 1639 | 7647 | 3655 | 1647 | 7316 | 3691 | 1660 | 7356 | 3760 | 1700 |

Important notice

Ensure there are air filters to keep the recovery unit's energy efficiency high, and regularly carry out cleaning and replacement maintenance. Read the instructions in the use and maintenance manual.

Warning

Always ensure a filter is used. To prevent reduced effectiveness of your energy recovery ventilation, be sure to clean dirt and dust from the filter and heat exchange element at regular intervals. See the operating instructions manual.

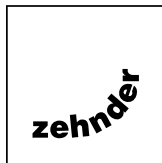

Scan to get
USER
manual!

A black rounded rectangular button containing a white QR code on the left and the text "Scan to get USER manual!" on the right.

Scan to get
INSTALLER
manual!

A black rounded rectangular button containing a white QR code on the left and the text "Scan to get INSTALLER manual!" on the right.